

MFBIO-III-T User Manual

Index

- A. **Set up software connection Error! Bookmark not defined.**
- B. **Registration of user data Error! Bookmark not defined.**

A. Set up software connection

1. Press "F1" twice, and enter administrator password (default is: 111111) and press "#" to confirm the set up.
2. Press "1" for Quick Setup
(Press "#" to enter setup mode, Press "*" to skip)

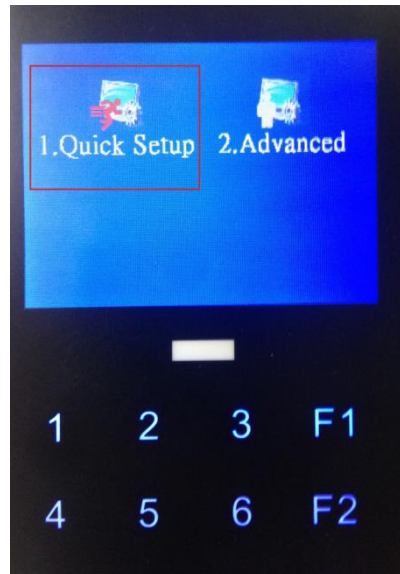

3. Set Terminal ID
Terminal ID is for software identification, default is: 1, terminal ID range from 1 to 65535 and ID cannot be repeated with same software connection.
4. Set Software IP
Use same IP as the PC which installed with SOMCA (Please use static IP for PC)

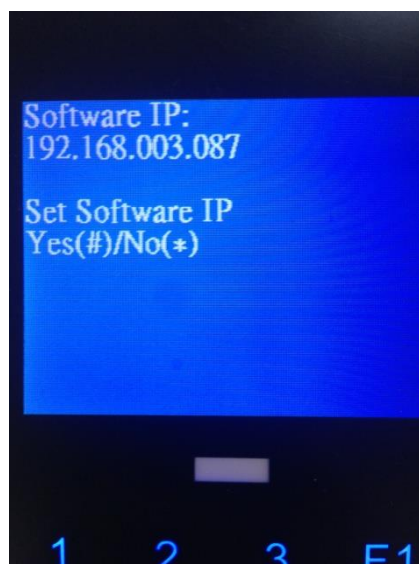

5. Set SW Port

Default as 2000 (The default rate is recommended)

6. TCP/IP Setup

If IP setting is necessary, there are 2 ways of setting IP. See following steps

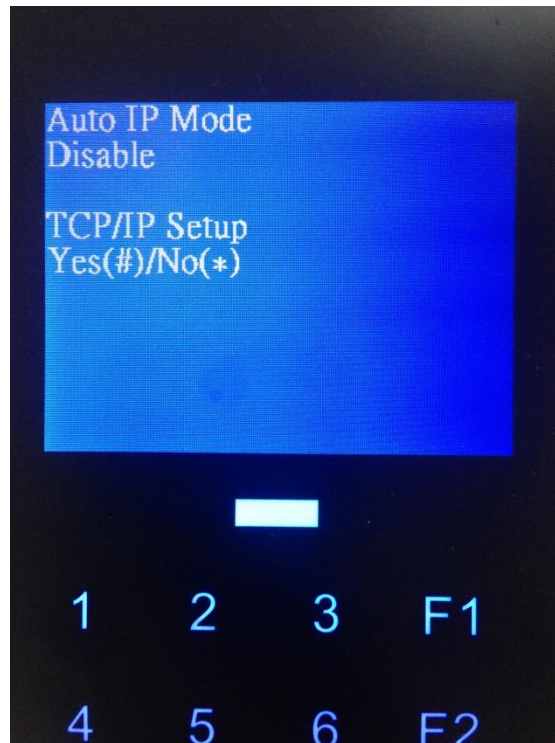

a. Auto IP Mode

Machine will use DHCP to get IP address automatically. If manual IP set up is required, please press "*"

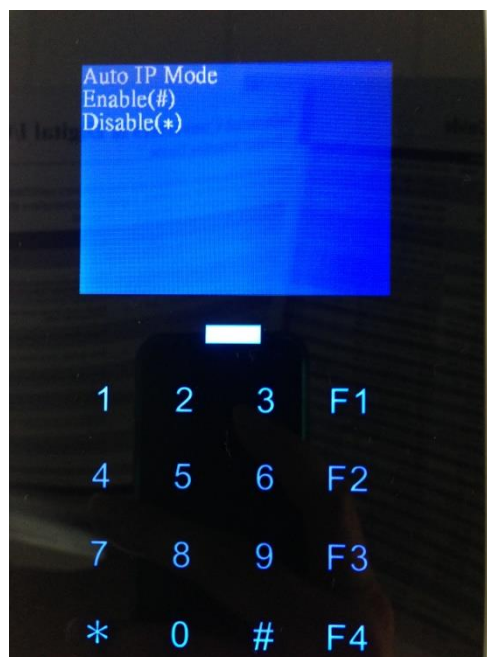

b. Set Terminal IP

Manual IP setting: sequentially enter terminal IP, subnet mask and default gateway

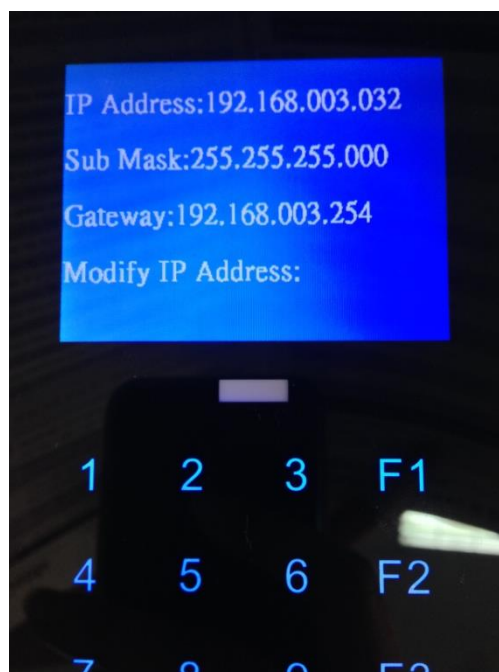
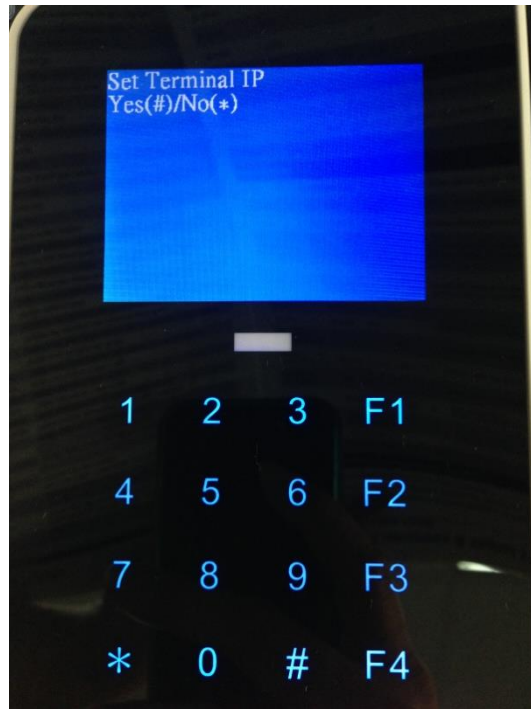

7. Set Bypass Mode

To enable or disable special bypass mode, please skip this option when using standard access control.

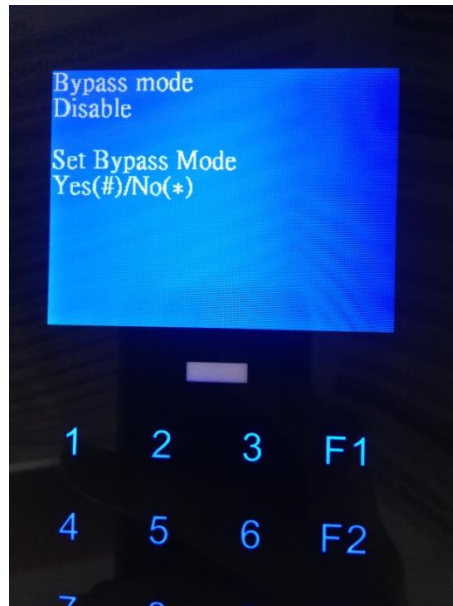

8. Save setting

Press “#” to save the set up, and the machine will be rebooted automatically.

When connection with software is successful, you will see “@” on screen as confirmation.

B. Registration of user data

1. Press "F1" twice and enter password (default is: 111111) and press "#" to confirm.
2. Choose 2. "Advanced"

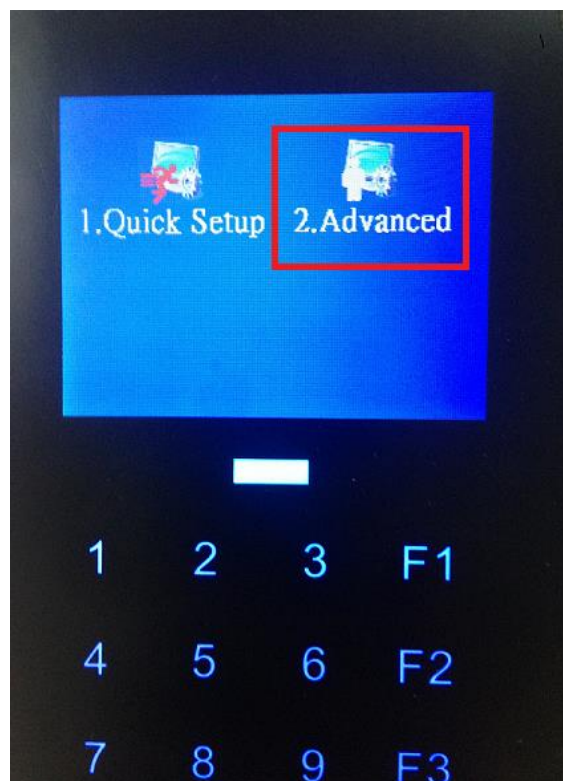

3. Choose 1. "user" to set up

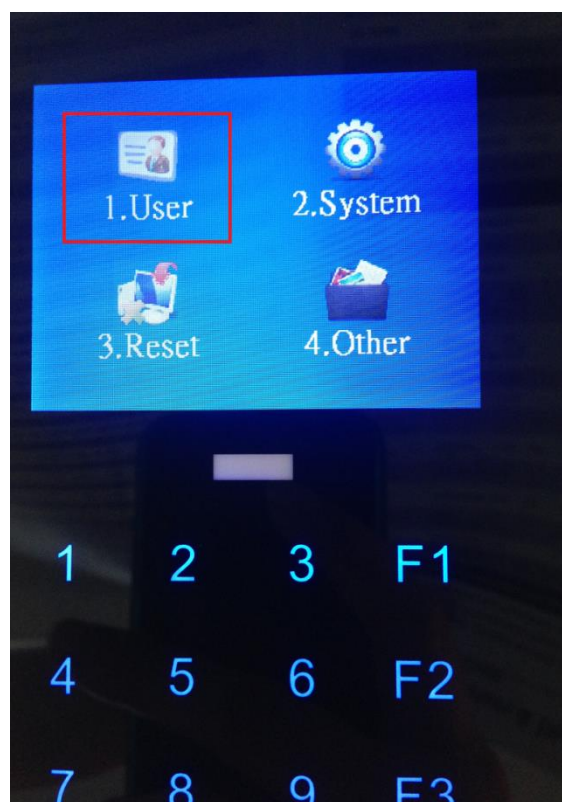

4. Choose 1. "Add user"

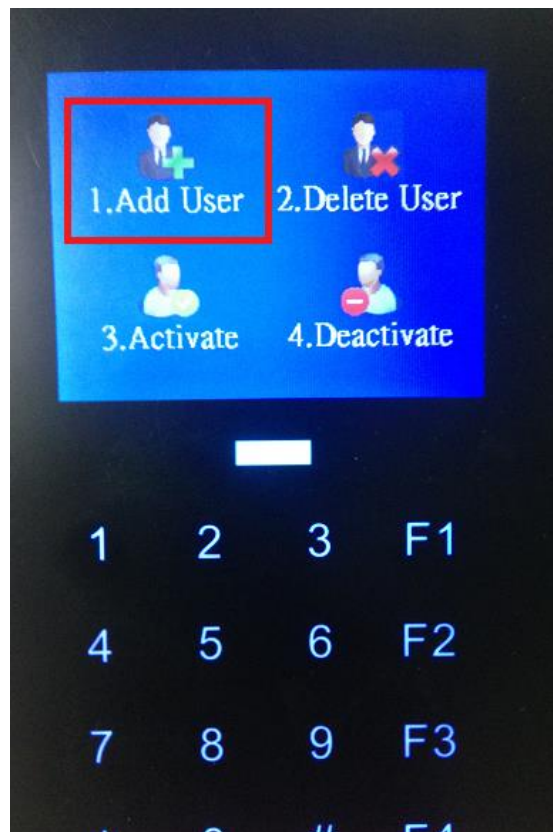

1. Single Registration

To register one user, according to user ID, card ID, fingerprint, password and different passing level, one user can register 2 fingerprints; each fingerprint needs to be collected twice. To skip card number, fingerprint, password, press "*", to skip passing level, press "#"

2. Multi Users Registration

After enter user ID, swipe cards which need to be registered uninterruptedly (this function is for card user only), and those cards can be used after registration.